

SeriesLock[®] Xgen

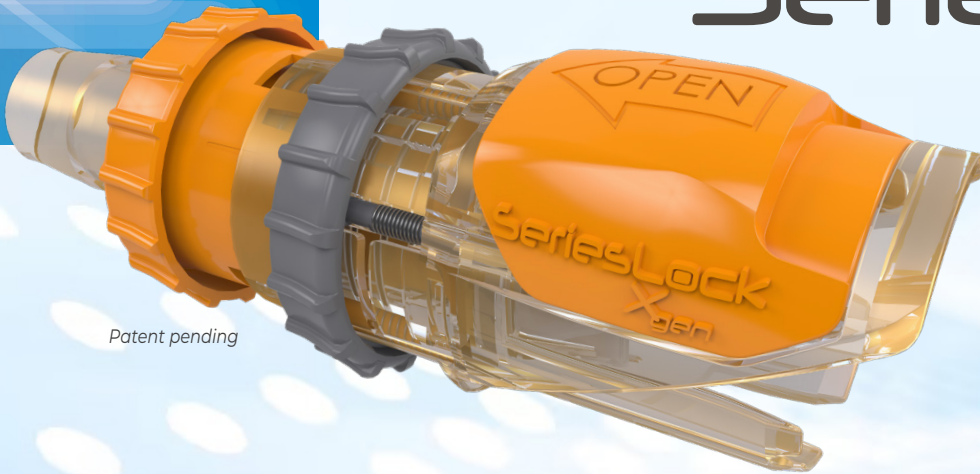

Patent pending

SeriesLock Xgen™ Genderless Multi-Connect CDR

SeriesLock Xgen™ is an intuitive, easy to use genderless sterile quick-disconnect solution. Xgen genderless quick connect technology is revolutionizing the bioprocessing industry by offering a more efficient, versatile, and reliable solution for connecting equipment and processes.

Xgen is revolutionary with a small footprint of 3.6" per half and 5.1" connected. Recessed mating features protect contact surfaces and allows for a sterile, leak free connection, disconnection, and reconnection up to 10 times even in gray spaces.

This genderless connector is manufactured with ISO 10993 compliant materials. The housing is constructed of polysulfone (PSU), virgin flow path, class VI silicone seals.

The audible click upon connection, the locking rings and the safety slide release are features to help prevent accidental disconnects.

Standard sizes are available to accommodate tubing sizes ranging from 1/4" ID to 1" ID Tubing.

Product Features:

- Sterile single-use connection that disconnects and reconnects up to ten times.
- Safety lock-out feature when connector valve is open and flowing does not allow for an accidental disconnect.
- Reduces inventory with single part numbers in both halves of a symmetrical assembly.
- Audible click confirms proper connection.
- Bi-directional flow.
- Polysulfone housing for toughness and stability at high temperatures.
- High pressure (60psi, 4.1 bar) when connected.
- Autoclave and Gamma stable for sterilization.



ELDON JAMES

970-667-2728

Sales @eldonjames.com

Patents: <https://serieslock.com/patents/> and patents pending

FEATURE AND BENEFITS

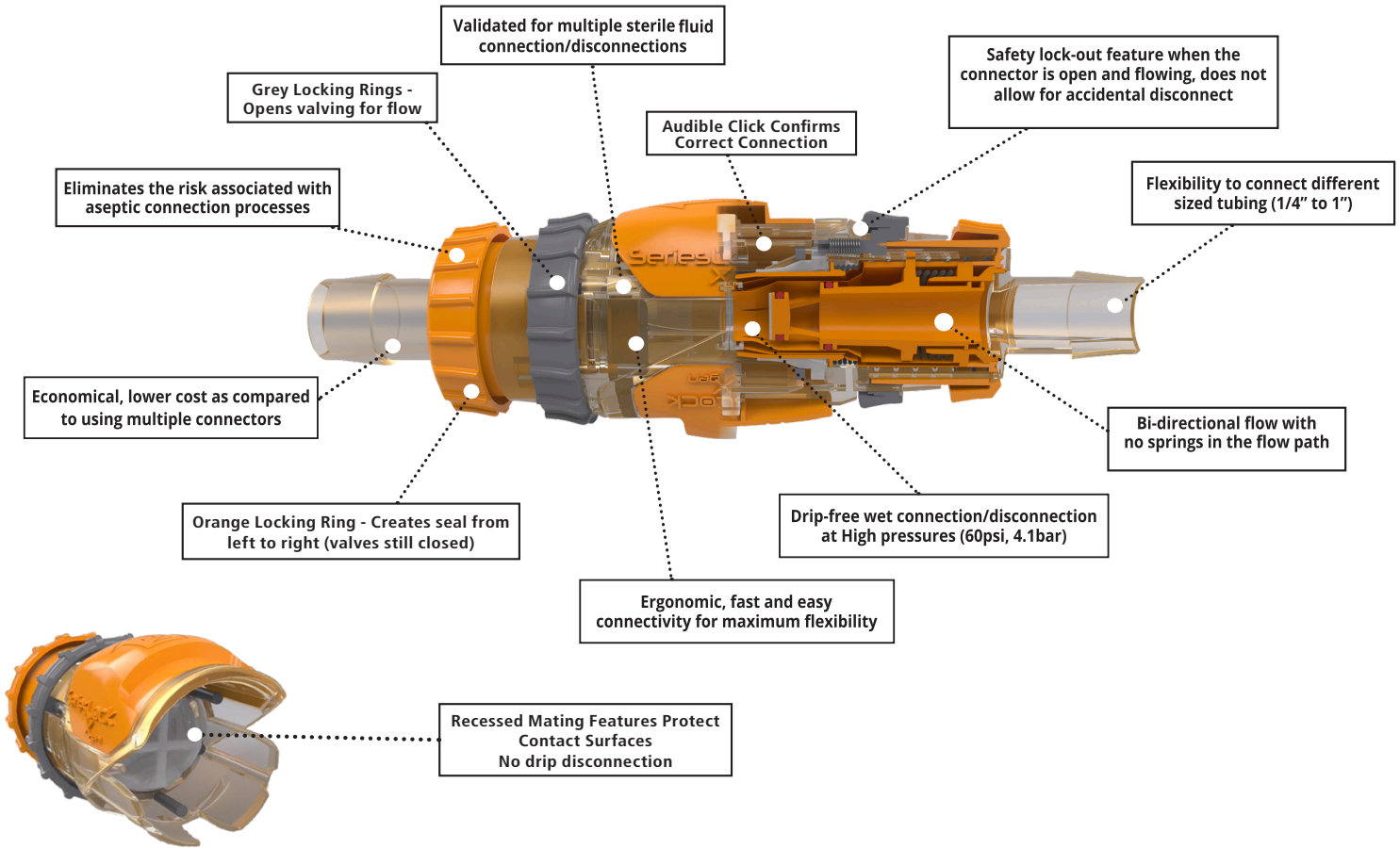

EASY ASSEMBLY

SeriesLock Xgen™ is easy to assemble.

1. Push unit together until a click is heard.
2. Push orange rings towards center and twist to lock.
3. Push grey rings towards center and twist to lock.
4. Assembly complete.

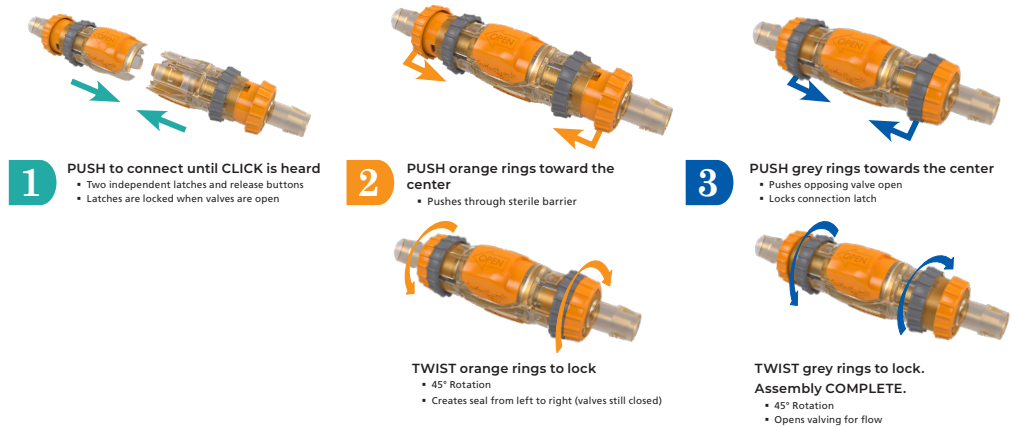

ELDON JAMES

3486 Precision Drive
Fort Collins, CO 80528

970-667-2728

sales@eldonjames.com

eldonjames.com

Explore the Serieslock® Family of Products
WWW.SERIESLOCK.COM



SeriesLock[®] Xgen

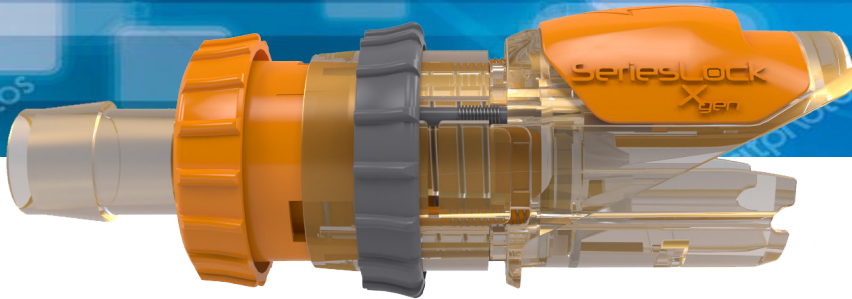

Patent pending

SeriesLock Xgen™ Genderless Multi-Use Connector

SeriesLock Xgen is an intuitive, easy to use genderless sterile quick-disconnect solution that allows the connector to be disconnected, and reconnected up to ten times. This spring-free flow path[®] genderless connector allows a larger volume of fluid to pass through at lower line pressures.

Xgen is revolutionary with a small footprint of 3.6" per half and 5.1" connected. Recessed mating features protect contact surfaces and allow for a sterile connection or reconnection even in gray spaces.

This genderless connector is manufactured with ISO 10993 compliant materials. The housing is constructed of polysulfone (PSU), virgin flow path, class VI silicone seals, and polycarbonate (PC) button/latches

The audible click upon connection, the locking rings and the safety slide release are features to help accidental disconnects.

Standard sizes are available to accommodate tubing sizes ranging from 1/4" ID to 1" ID Tubing.

Product Features:

- Sterile single-use connection that disconnects and reconnects up to ten times.
- Reduces inventory with single part numbers in both halves of a symmetrical assembly.
- Ability to combine multiple tubing sizes intuitive, simple to connect and disconnect.
- Audible click confirm proper connection.
- Bi-directional flow.
- Polysulfone housing for toughness and stability at high temperatures.
- High pressure (60psi, 4.1 bar) when connected.
- Autoclave and Gamma stable for sterilization.



970-667-2728

Sales @eldonjames.com

Patents: <https://serieslock.com/patents/> and patents pending

Instruction Booklet

SeriesLock® Xgen

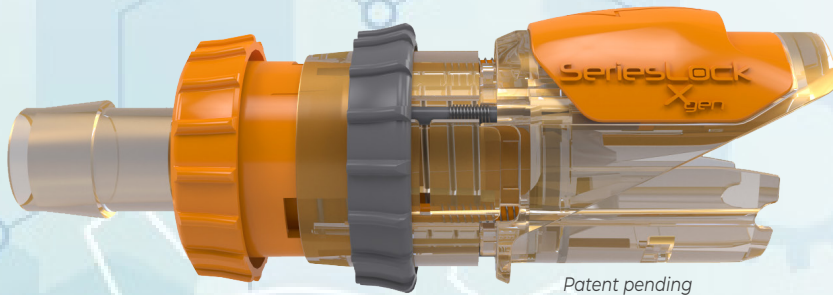

SeriesLock® Xgen™ Genderless Multi-Use Connector

SeriesLock® Xgen is an intuitive, easy to use genderless sterile quick-disconnect solution that allows the connector to be disconnected, and reconnected up to ten times. This spring-free flow path® genderless connector allows a larger volume of fluid to pass through at lower line pressures.

Xgen is revolutionary with a small footprint of 3.6" per half and 5.1" connected. Recessed mating features protect contact surfaces and allow for a sterile connection or reconnection even in gray spaces.

This genderless connector is manufactured with ISO 10993 compliant materials. The housing is constructed of polysulfone (PSU), virgin flow path, class VI silicone seals, and polycarbonate (PC) button/latches

The audible click upon connection, the locking rings and the safety slide release are features to help accidental disconnects.

Standard sizes are available to accommodate tubing sizes ranging from 1/4" ID to 1" ID Tubing.

Product Features:

- Sterile single-use connection that disconnects and reconnects up to ten times.
- Reduces inventory with single part numbers in both halves of a symmetrical assembly.
- Ability to combine multiple tubing sizes intuitive, simple to connect and disconnect.
- Audible click confirm proper connection.
- Bi-directional flow.
- Polysulfone housing for toughness and stability at high temperatures.
- High pressure (60psi, 4.1 bar) when connected.
- Autoclave and Gamma stable for sterilization.



970-667-2728

Sales @eldonjames.com

Patents: <https://serieslock.com/patents/> and patents pending



Patent pending

SeriesLock®
Xgen

SeriesLock® Xgen™ Genderless Multi-Use Connector

SeriesLock® Xgen is an intuitive, easy to use genderless sterile quick-disconnect solution that allows the connector to be disconnected, and reconnected up to ten times. This spring-free flow path® genderless connector allows a larger volume of fluid to pass through at lower line pressures.

Xgen is revolutionary with a small footprint of 3.6" per half and 5.1" connected. Recessed mating features protect contact surfaces and allow for a sterile connection or reconnection even in gray spaces.

This genderless connector is manufactured with ISO 10993 compliant materials. The housing is constructed of polysulfone (PSU), virgin flow path, class VI silicone seals, and polycarbonate (PC) button/latches

The audible click upon connection, the locking rings and the safety slide release are features to help accidental disconnects.

Standard sizes are available to accommodate tubing sizes ranging from 1/4" ID to 1" ID Tubing.

Product Features:

- Sterile single-use connection that disconnects and reconnects up to ten times.
- Reduces inventory with single part numbers in both halves of a symmetrical assembly.
- Ability to combine multiple tubing sizes intuitive, simple to connect and disconnect.
- Audible click confirm proper connection.
- Bi-directional flow.
- Polysulfone housing for toughness and stability at high temperatures.
- High pressure (60psi, 4.1 bar) when connected.
- Autoclave and Gamma stable for sterilization.

970-667-2728

Sales @eldonjames.com

Patents: <https://serieslock.com/patents/> and patents pending

SeriesLock® Xgen

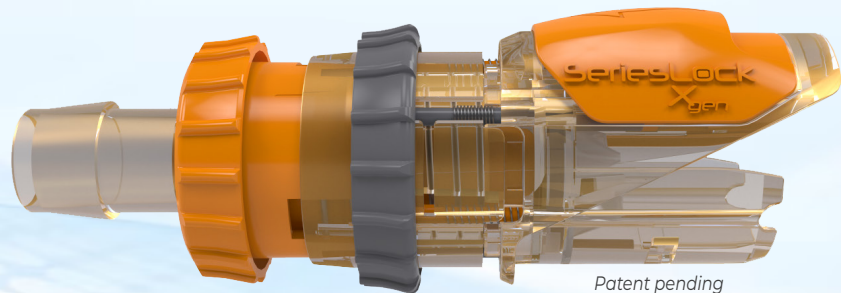

SeriesLock® Xgen™ Genderless Multi-Use Connector

SeriesLock® Xgen is an intuitive, easy to use genderless sterile quick-disconnect solution that allows the connector to be disconnected, and reconnected up to ten times. This spring-free flow path® genderless connector allows a larger volume of fluid to pass through at lower line pressures.

Xgen is revolutionary with a small footprint of 3.6" per half and 5.1" connected. Recessed mating features protect contact surfaces and allow for a sterile connection or reconnection even in gray spaces.

This genderless connector is manufactured with ISO 10993 compliant materials. The housing is constructed of polysulfone (PSU), virgin flow path, class VI silicone seals, and polycarbonate (PC) button/latches

The audible click upon connection, the locking rings and the safety slide release are features to help accidental disconnects.

Standard sizes are available to accommodate tubing sizes ranging from 1/4" ID to 1" ID Tubing.

Product Features:

- Sterile single-use connection that disconnects and reconnects up to ten times.
- Reduces inventory with single part numbers in both halves of a symmetrical assembly.
- Ability to combine multiple tubing sizes intuitive, simple to connect and disconnect.
- Audible click confirm proper connection.
- Bi-directional flow.
- Polysulfone housing for toughness and stability at high temperatures.
- High pressure (60psi, 4.1 bar) when connected.
- Autoclave and Gamma stable for sterilization.

970-667-2728

Sales @eldonjames.com

Patents: <https://serieslock.com/patents/> and patents pending

SeriesLock® Xgen



SeriesLock® Xgen™ Genderless Multi-Use Connector

SeriesLock® Xgen is an intuitive, easy to use genderless sterile quick-disconnect solution that allows the connector to be disconnected, and reconnected up to ten times. This spring-free flow path® genderless connector allows a larger volume of fluid to pass through at lower line pressures.

Xgen is revolutionary with a small footprint of 3.6" per half and 5.1" connected. Recessed mating features protect contact surfaces and allow for a sterile connection or reconnection even in gray spaces.

This genderless connector is manufactured with ISO 10993 compliant materials. The housing is constructed of polysulfone (PSU), virgin flow path, class VI silicone seals, and polycarbonate (PC) button/ latches

The audible click upon connection, the locking rings and the safety slide release are features to help accidental disconnects.

Standard sizes are available to accommodate tubing sizes ranging from 1/4" ID to 1" ID Tubing.

970-667-2728

Sales @eldonjames.com

Patents: <https://serieslock.com/patents/> and patents pending

SeriesLock® Xgen



SeriesLock® Xgen™ Genderless Multi-Use Connector

SeriesLock® Xgen is an intuitive, easy to use genderless sterile quick-disconnect solution that allows the connector to be disconnected, and reconnected up to ten times. This spring-free flow path® genderless connector allows a larger volume of fluid to pass through at lower line pressures.

Xgen is revolutionary with a small footprint of 3.6" per half and 5.1" connected. Recessed mating features protect contact surfaces and allow for a sterile connection or reconnection even in gray spaces.

This genderless connector is manufactured with ISO 10993 compliant materials. The housing is constructed of polysulfone (PSU), virgin flow path, class VI silicone seals, and polycarbonate (PC) button/ latches

The audible click upon connection, the locking rings and the safety slide release are features to help accidental disconnects.

Standard sizes are available to accommodate tubing sizes ranging from 1/4" ID to 1" ID Tubing.

970-667-2728

Sales @eldonjames.com

Patents: <https://serieslock.com/patents/> and patents pending

FEATURE AND BENEFITS

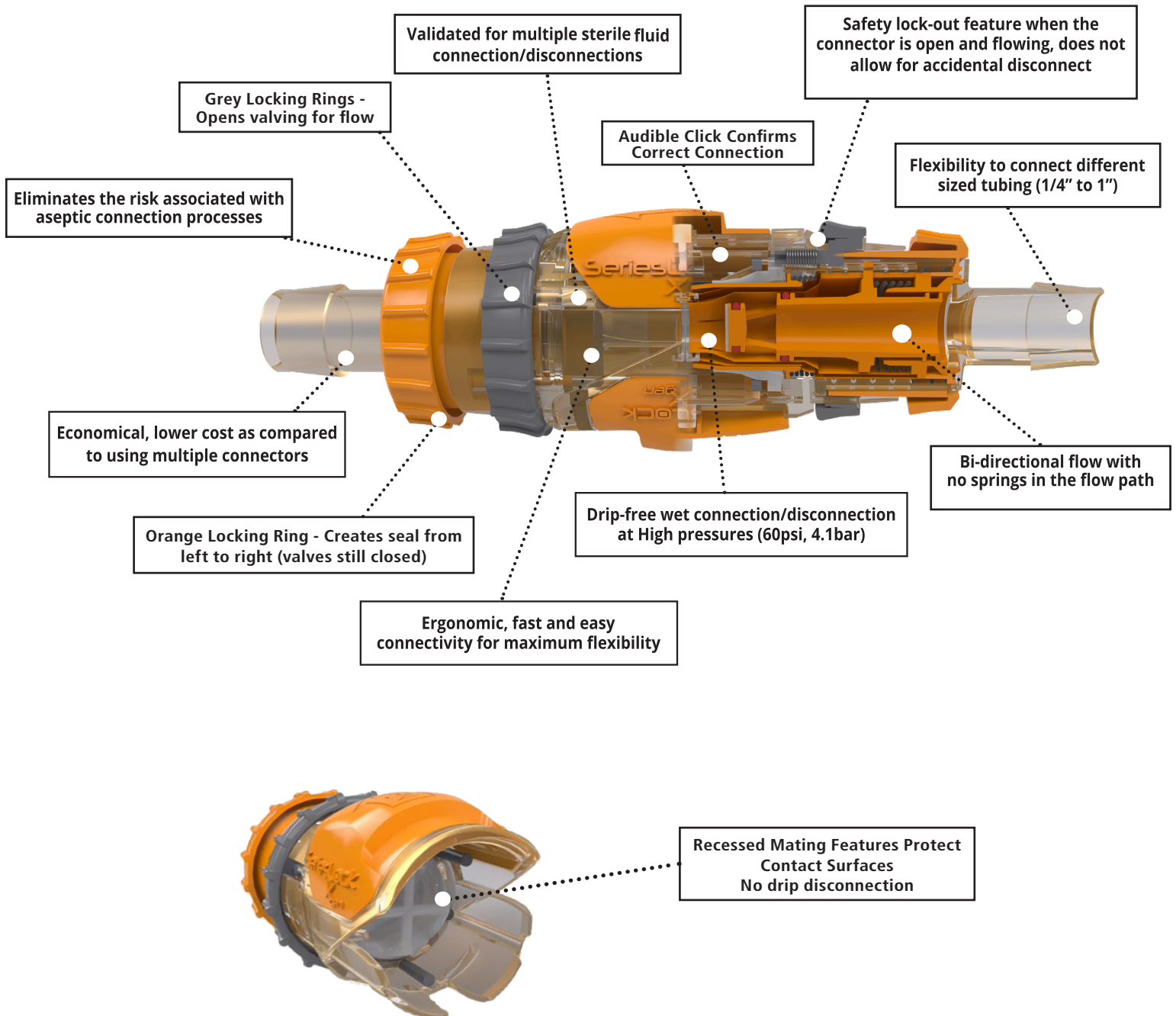

SeriesLock®
Xgen

TESTING ANALYSIS AND VALIDATION

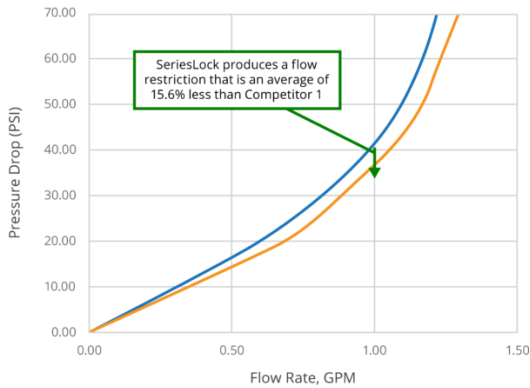

WATER FLOW – 1/8" Barb Fittings			
FLOW RATE (GPM)	PRESSURE DROP (PSI)		PERCENT CHANGE (PSI) ²
	SeriesLock	Competitor 1	
0.00	0.00	0.00	0.00%
0.60	16.08	20.00	-19.61%
0.90	31.01	35.00	-11.40%
1.10	43.20	50.00	-13.61%
1.20	54.24	66.00	-17.82%

SeriesLock[®] produces a flow restriction that is an average of 15.6% less than Competitor 1

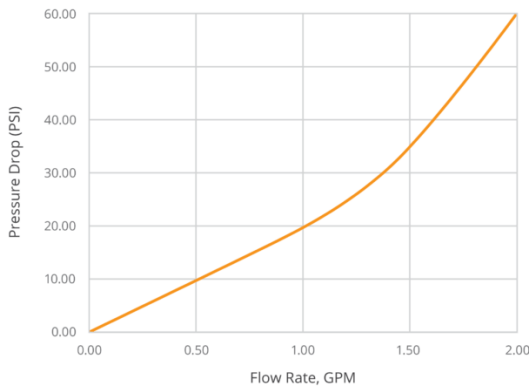

WATER FLOW – 3/16" Barb Fittings			
FLOW RATE (GPM)	PRESSURE DROP (PSI)		PERCENT CHANGE (PSI) ²
	SeriesLock	Competitor 1	
0.00	0.00	0.00	0.00%
0.60	16.08	0.00	0.00%
0.90	31.01	0.00	0.00%
1.10	43.20	0.00	0.00%
1.20	54.24	0.00	0.00%

No competitor product commercially available at this time.

INTERNAL SURFACE AREAS (IN²)

SMALL BODY (- 2 / - 3)

Open Female	0.88
Valved Female	0.97
Open Male	2.67
Valved Male	1.55

MEDIUM BODY (- 4 / - 5 / - 6)

Open Female	1.64
Valved Female	1.99
Open Male	3.72
Valved Male	2.37

LARGE BODY (- 8 / - 10 / - 12)

Open Female	5.01
Valved Female	6.11
Open Male	8.99
Valved Male	6.36

ORDERING

Tubing Size	Part Number	O-ring	Spring

Tubing Size	Part Number	O-ring	Spring

EASY ASSEMBLY

SeriesLock® Xgen is easy to assembly.

1. Push unit together until a click is heard.
2. Push orange rings towards center and twist to lock.
3. Push grey rings towards center and twist to lock.
4. Assembly complete.

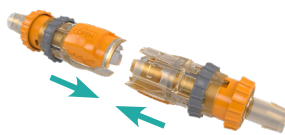

1 PUSH to connect until CLICK is heard

- Two independent latches and release buttons
- Latches are locked when valves are open



2 PUSH orange rings toward the center

- Pushes through sterile barrier



TWIST orange rings to lock

- 45° Rotation
- Creates seal from left to right (valves still closed)



3 PUSH grey rings towards the center

- Pushes opposing valve open
- Locks connection latch



TWIST grey rings to lock.
Assembly COMPLETE.

- 45° Rotation
- Opens valving for flow



ELDON JAMES

3486 Precision Drive
Fort Collins, CO 80528

970-667-2728
sales@eldonjames.com
eldonjames.com

Explore the Serieslock® Family of Products
WWW.SERIESLOCK.COM



