

# SeriesLock Xgen®

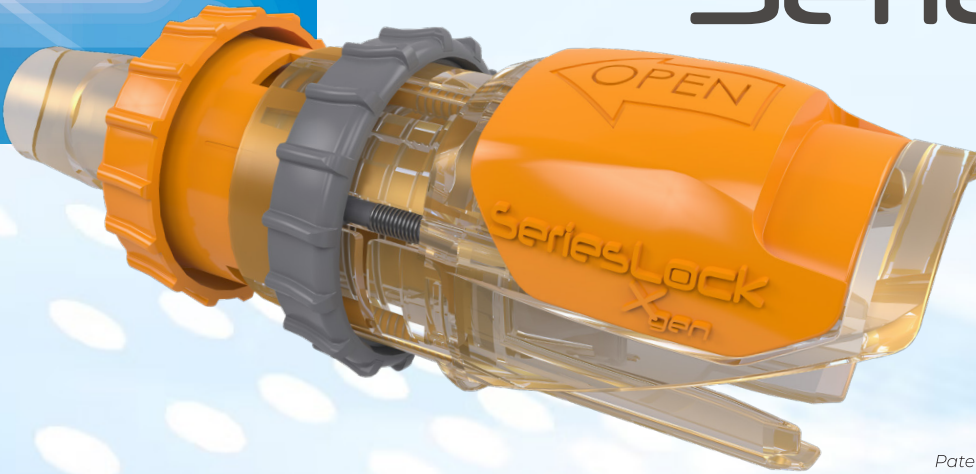

Patents: <https://serieslock.com/patents/> and patents pending

## SeriesLock Xgen® Genderless Multi-Connect CDR

The SeriesLock Xgen® CDR coupler is an intuitive, easy to use genderless sterile quick-disconnect solution. Xgen genderless quick connect technology is revolutionizing the bioprocessing industry by offering a more efficient, versatile, and reliable solution for connecting equipment and processes.

SeriesLock Xgen is revolutionary with a small footprint of 3.6" per half and 5.1" connected. Recessed mating features protect contact surfaces and allows for a sterile, leak free connection, disconnection, and reconnection up to 10 times even in gray spaces.

This genderless connector is manufactured with ISO10993 compliant materials. All fluid contacting components are constructed from polysulfone (PSU) and incorporate Class VI silicone seals.

The audible click upon connection, the locking rings, and the safety slide release are features to help prevent accidental disconnects. Standard sizes are available to accommodate tubing sizes ranging from 1/4" ID to 1" ID tubing in a barb and sanitary flange configuration.

**POWER  
of 10X**

### Product Features:

- Sterile CDR that disconnects and reconnects up to ten times
- Safety lock-out feature when connector valve is open and flowing does not allow for an accidental disconnect.
- Reduces inventory with single part numbers in both halves of a symmetrical assembly.
- Audible click confirms proper connection.
- Bi-directional flow.
- Polysulfone housing for toughness and stability at high temperatures.
- Operating pressures to 25psi (1.72 bar)
- E-beam, Autoclave and Gamma sterilization stable.



Patents: <https://serieslock.com/patents/> and patents pending

**ELDON JAMES**

**970-667-2728**

**Sales @eldonjames.com**

# FEATURE AND BENEFITS

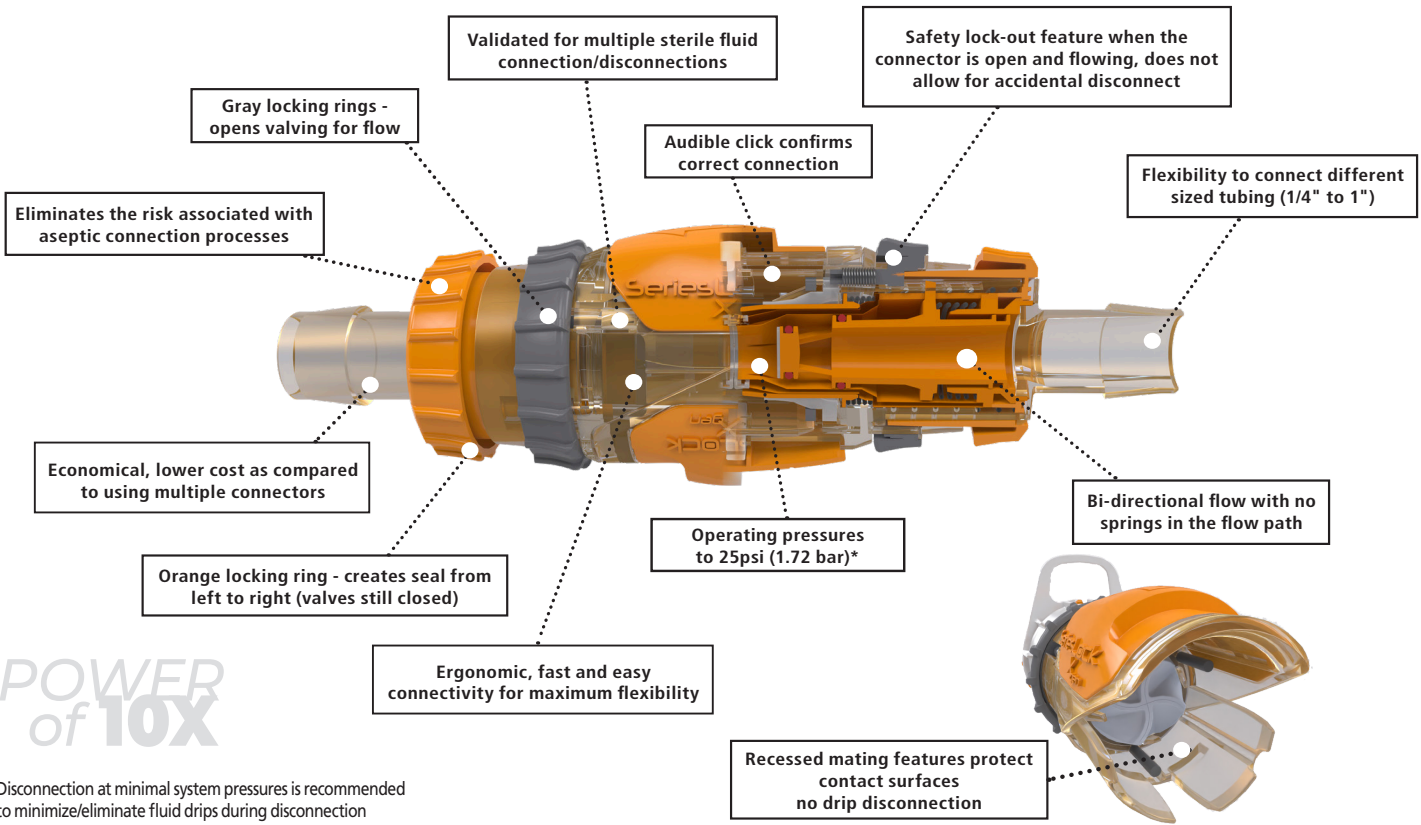

POWER of 10X

\* Disconnection at minimal system pressures is recommended to minimize/eliminate fluid drips during disconnection

## Valves CLOSED

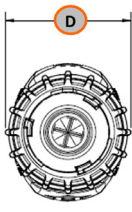
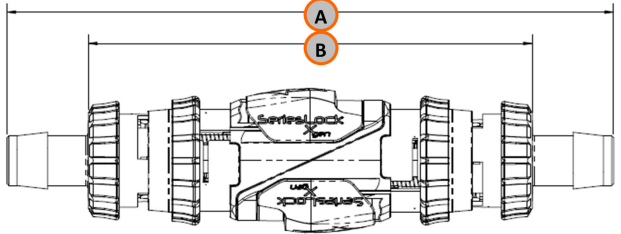

## Valves OPEN

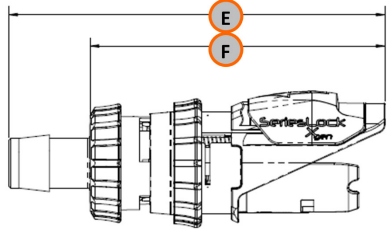
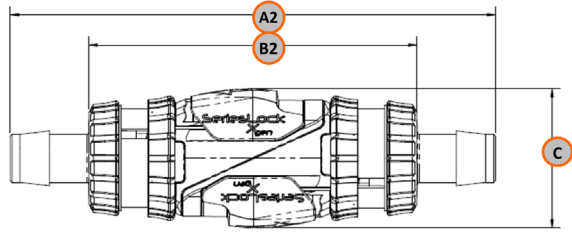

LEFT-TO-RIGHT CONNECTED - OPEN VS CLOSED VALVE								
Tubing Size	Barb Fittings (Dimensions in Inches)							
	A	B	A2	B2	C	D	E	F
1/4"	8.06	6.58	6.51	5.03	2.17	1.94	5.11	4.37
3/8"	8.26		6.71				5.21	
1/2"	8.58		7.03				5.37	
5/8"								
3/4"	8.98		7.43				5.57	
1"	9.38		7.83				5.77	

bioklik  
ASSEMBLIES



## TESTING ANALYSIS AND VALIDATION

### SERIESLOCK XGEN SPECIFICATIONS

Working Pressure	25psi, 1.72 bar
Storage Temperature Range	-112°F to 302°F (-80°C to 150°C)
Service Temperature Range	-4°F to 302°F (-20°C to 150°C)

### STERILIZATION METHODS

	Gamma	E-Beam	ETO	Autoclave	
				121°C	134°C
Polysulfone	Yes	Yes	Yes	Yes	Yes

#### Irradiation

- Typical radiation cycle <50 kGy (end user to verify their use environment and sterilization cycle validations).

#### Autoclave

- 121°C for 30 minutes (unwrapped) followed by 15-30 minutes drying time.
- 134°C for 15 minutes (unwrapped) followed by 15-30 minutes drying time.

### INTERNAL SURFACE AREA AND VOLUMES

Tubing Size	Barb Fittings (Dimensions in Inches)							
	A	B	A2	B2	C	D	E	F
1/4"	8.06	6.58	6.51	5.03	2.17	1.94	5.11	4.37
3/8"	8.26		6.71				5.21	
1/2"	8.58		7.03				5.37	
5/8"								
3/4"	8.98		7.43				5.57	
1"	9.38		7.83				5.77	

### CIRCULATION VOLUMES

Tubing Size	Flow (GPM)
3/8"	1.01
1/2"	1.765
5/8"	
3/4"	2.375
1"	2.394

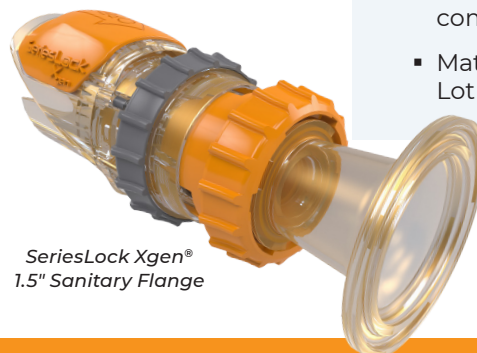

SeriesLock Xgen®  
1.5" Sanitary Flange

### INTERNAL SURFACE AREA AND VOLUMES

Tubing Size	Surface Area (cm <sup>2</sup> )	Volume (cc)	HOLD-UP Volume (1) (cc)
1/4"	35.40	8.88	0.002
3/8"	37.43	9.49	
1/2"	40.30	10.57	
5/8"			
3/4"	44.97	14.93	
1"	56.45	20.94	

### WEIGHTS (GRAMS) – ONE HALF ONLY

Tubing Size	Polysulfone Housing
1/4"	87
3/8"	87
1/2"	88
5/8"	
3/4"	90
1"	94

### REGULATORY:

- Superior Bio Compatibility
- Ultra-low Extractables / Leachables
- USP Class VI Compliant
- REACH and RoHS Compliant
- ISO 10993-4 – Non-hemolytic
- ISO 10993-5 – Non-cytotoxic
- ISO 10933-10– Intracutaneous Reactivity and Irritation / Sensitization
- ISO 10933-11– Systemic Toxicity
- Non-animal derived – BSE/TSE compliant
- Material Certificate and Lot Traceability

## ORDERING

### SERIESLOCK XGEN®

Part Number	Autoclave Ready Part number	Description
B-XG-SO-SS-4-QC	B-XG-SO-SS-4AR-QC-B	Xgen, Valved Genderless, Polysulfone, Silicone O-Ring, SS Spring - 1/4" Barb
B-XG-SO-SS-6-QC	B-XG-SO-SS-6AR-QC-B	Xgen, Valved Genderless, Polysulfone, Silicone O-Ring, SS Spring - 3/8" Barb
B-XG-SO-SS-8-QC	B-XG-SO-SS-8AR-QC-B	Xgen, Valved Genderless, Polysulfone, Silicone O-Ring, SS Spring - 1/2" Barb
B-XG-SO-SS-10-QC	B-XG-SO-SS-10AR-QC-B	Xgen, Valved Genderless, Polysulfone, Silicone O-Ring, SS Spring - 5/8" Barb
B-XG-SO-SS-12-QC	B-XG-SO-SS-12AR-QC-B	Xgen, Valved Genderless, Polysulfone, Silicone O-Ring, SS Spring - 3/4" Barb
B-XG-SO-SS-16-QC	B-XG-SO-SS-16AR-QC-B	Xgen, Valved Genderless, Polysulfone, Silicone O-Ring, SS Spring - 1" Barb
SF12-XG-SO-SS-QC-B	SF12-XG-SO-SS-AR-QC-B	Xgen, Valved Genderless, Polysulfone, Silicone O-Ring, SS Spring - 3/4" Sanitary Flange
SF24-XG-SO-QC-B	SF24-XG-SO-AR-QC-B	Xgen, Valved Genderless, Polysulfone, Silicone O-Ring, SS Spring - 1.5" Sanitary Flange

For more information  
contact us at:  
970-667-2728  
Sales @eldonjames.com



For a Tutorial Video  
scan QR Code.

ACCESSORIES	
Part Number	Description
XGEN-P	Xgen, Dust Cover Plug
XGEN-BKT	Xgen, White Bracket



SeriesLock Xgen®  
Autoclave Ready

## EASY ASSEMBLY

SeriesLock Xgen® is easy to assembly.

1. Push unit together until a click is heard.
2. Push orange rings towards center and twist to lock.
3. Push gray rings towards center and twist to lock.
4. Assembly complete.

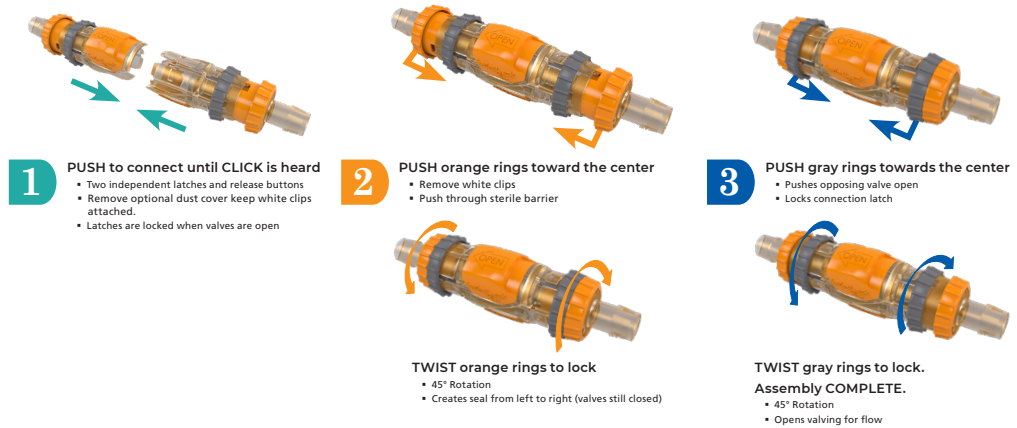

Explore the Serieslock® Family of Products  
[WWW.SERIESLOCK.COM](http://WWW.SERIESLOCK.COM)

**ELDON JAMES**

3486 Precision Drive  
Fort Collins, CO 80528

970-667-2728

sales@eldonjames.com

eldonjames.com

